

可選配之上塞高度
(TOP COVER IS OPTIONAL)

型號(MODEL NO.): H383(H384)

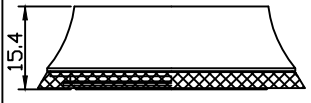

型號(MODEL NO.): H383M(H384M)



型號(MODEL NO.): H383H(H384H)

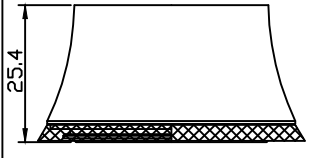

堆積高度(STACK HEIGHT)=9.5±1mm

| NO. | 零件名稱 PART NAME | 材質 MATERIAL | 圖號 ITEM NO. | 台量 Q'TY | 尺寸 DIM. DESCRIPTION |
|-----|----------------------------|----------------|--------------------|------------|---|
| 1 | O形圈 O-RING | 橡膠 NBR | 120-8 | 1 | ID28.5x ϕ 2 |
| 2 | 上塞 TOP COVER | 鋁合金 6061/T6 | 125-3 | 1 | 1-1/8" |
| 3 | 防塵蓋 DUST-RESISTED COVER | 塑膠 NYLON | 118-8 | 1 | |
| 4 | 鋁斜管 COMPRESSION RING | 鋁合金 6061/T6 | 773-2 | 1 | 1-1/8" |
| 5 | 密封軸承 AC SEALED BEARING | 軸承鋼 SUJ2 | NHB-5D | 1 | OD ϕ 41x36°x45° |
| 6 | 上碗 UPPER CUP | 鋁合金 6061/T6 | 146-4/5 | 1 | ϕ 44 ^{+0.15} ₋₀ |
| 7 | 下碗 LOWER CUP | 碳鋼 STEEL | 383-5 | 1 | ϕ 55 ^{+0.15} ₋₀ |
| 8 | 密封軸承 AC SEALED BEARING | 軸承鋼 SUJ2 | NHB-15 | 1 | OD ϕ 52x45°x45° |
| 9 | 下塞 CROWN RACE | 碳鋼 STEEL | 151S-6 (153S-6) | 1 | ϕ 39.8(ϕ 30) ⁺⁰ _{-0.1} |

- 半隱藏式車頭碗組
- 1.5" 轉1-1/8" 前叉立管
- 車頭管外徑上小下大
(建議車頭管外徑上半部50mm, 下半部61mm)
- 鋁合金(6061)上塞及上碗
- 碳鋼下碗對應H383及H384, 鋁合金下碗對應H383A及H384A
- 碳鋼下塞 (內徑39.8mm或30mm)
斜接觸角度密封式軸承(下半部軸承加大)

- For 1-1/8" upper, 1.5" bottom steerer
- For different outerdiameter head tube
- 6061/T6 top cover with seals
- 6061/T6 forged and cnc machined upper cup
- Steel cold-forged and cnc machined lower cup
- 6061/T6 cnc machined lower cup
- Steel cnc machined crown race
(inner diameter 39.8mm or 30mm)
- Upper: angular contact sealed bearing
Lower: super oversize angular contact sealed bearing

| | | | | | | | | |
|-----------------|--|-----------------|-----|--------------------|-----------------------|------------|----------|---|
| 單位 UNIT | mm | 比例 SCALE | 1:1 | 日期 DRAWING DATE | 2016.06.27 | 角法 VIEW | | |
| 型號 ITEM NO. | NECO H383/H383M/H383H/H384/H384M/H384H/H383A/H383AM/H383AH/H384A/H384AM/H384AH | | | | | | 版次(REV): | A |
| 品名 ITEM NAME | NECO H383/H383M/H383H/H384/H384M/H384H/H383A/H383AM/H383AH/H384A/H384AM/H384AH 組立圖(Assembly drawing) | | | | | | | |
| 規格 DIMENSION | 1-1/8" x44/50x55/61x39.8(30) | | | | | | | |
| 圖號 FIG. NO. | H383(H383M/H383H/H384/H384M/H384H)-組立圖-A | | | | | | | |
| 編號 NO. | 更改內容(MODIFIED RECORD) | | | 更改者 MODIFIER | 修改日期 MODIFIED DATE | | | |
| 製圖 DRAWER | 何明諭 | 核准 PROOFREAD | | 核准 APPROBATION | | | | |